

# Project Alpha

## Agriculture Applications

SPIN CRAFT ENGINE	
Engine type	Single cylinder, Naturally Aspirated
Emission level	Trem V
Bore / Stroke	100 mm X 120 mm
Engine capacity	943 cc
Rated Power Output	20 HP @ 2400 rpm
Rated Torque Output	60 Nm @ 1500 rpm
Cooling system	Air - Oil cooled
Valvetrain	4 valves, Pushrod type
Engine weight	120 kg

# Project Vayu UAV Engines

In House Design & Development

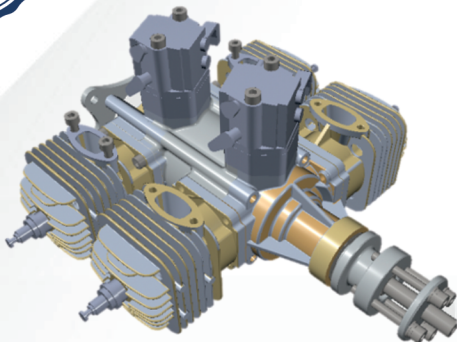
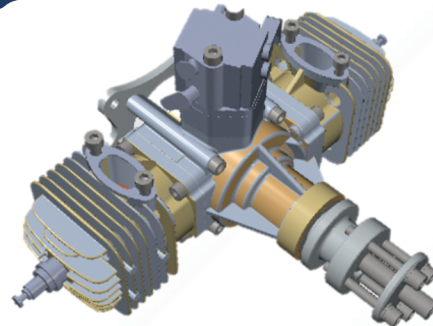
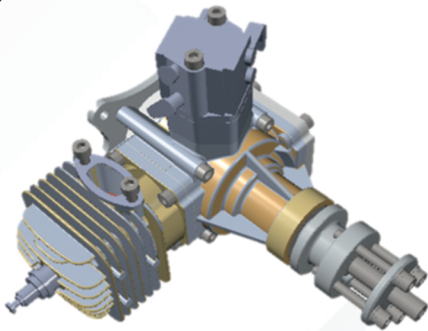

- Compact Gasoline engines
- Light weight design
- 4 hp to 80 hp
- 1-to-4-cylinder engines
- DI & PFI engines
- In-House ECU

Modular Engine family with up to 70% common parts across engine configurations.

